

HIGH POINT MANOR

www.HIGHPOINTMANOR.net



LOT 2, 5351 NORTHLAND DRIVE
\$1,199,000 **Giles Properties**
0.62+/- Acres **5BRs/4B/1HB**

Located just outside Atlanta city limits and minutes to 400, I-285, & Northside hospital
Built with a rustic elegance; 4" walnut floors, fine cabinetry, and beautiful stone work throughout
Diagonal Keeping Room with cathedral beamed ceiling, floor-to-ceiling stone fireplace, & built-ins
Fireside Family Room with coffered ceiling, wall of windows, and built-in bookcases
Handsome paneled Study with vaulted beamed ceiling & built-ins; large Dining Room with tray ceiling
State-of-the-art Kitchen with granite counters, large island with black walnut top, and 2 dishwashers
Master on main w/ tray ceiling; bath with granite surround tub, shower with multi-jets, gorgeous tile work
Upstairs: 3 large bedrooms, each with private bathroom and beautiful trim work, plus bonus / media room
Vaulted Covered Porch with fp, wired for TV above, exotic Brazilian wooden floors, & cypress ceiling
3-car garage and 3 fireplaces. Room for pool & play area

Exclusive Listing Agents:

Elsie & Laura Thompson
404-814-5421 dir/vm
elsie.thompson@harrynorman.com
www.ThompsonTeamAtlanta.com

FMLS: 3784535
MC: 739A6



Herbert Eustis, Broker - Bill Murray, Associate Managing Broker *www.harrynorman.com* 404-233-1492 3744 Roswell Road, Atlanta 30342
This information is believed to be accurate but not warranted. Offer subject to errors, changes, omissions, prior sales and withdrawals without notice.



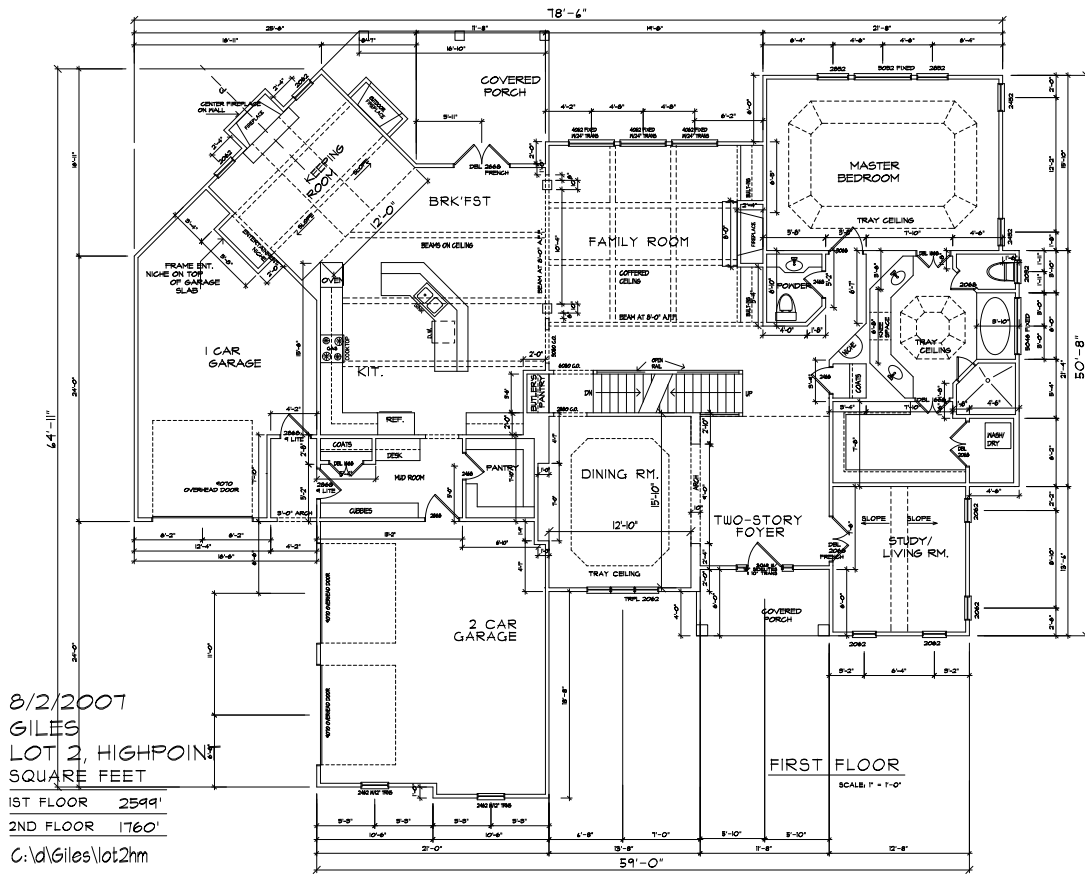

8/2/2007
 GILES
 LOT 2, HIGHPOINT
 SQUARE FEET
 1ST FLOOR 2594'
 2ND FLOOR 1760'
 C:\d\Giles\lot2hm

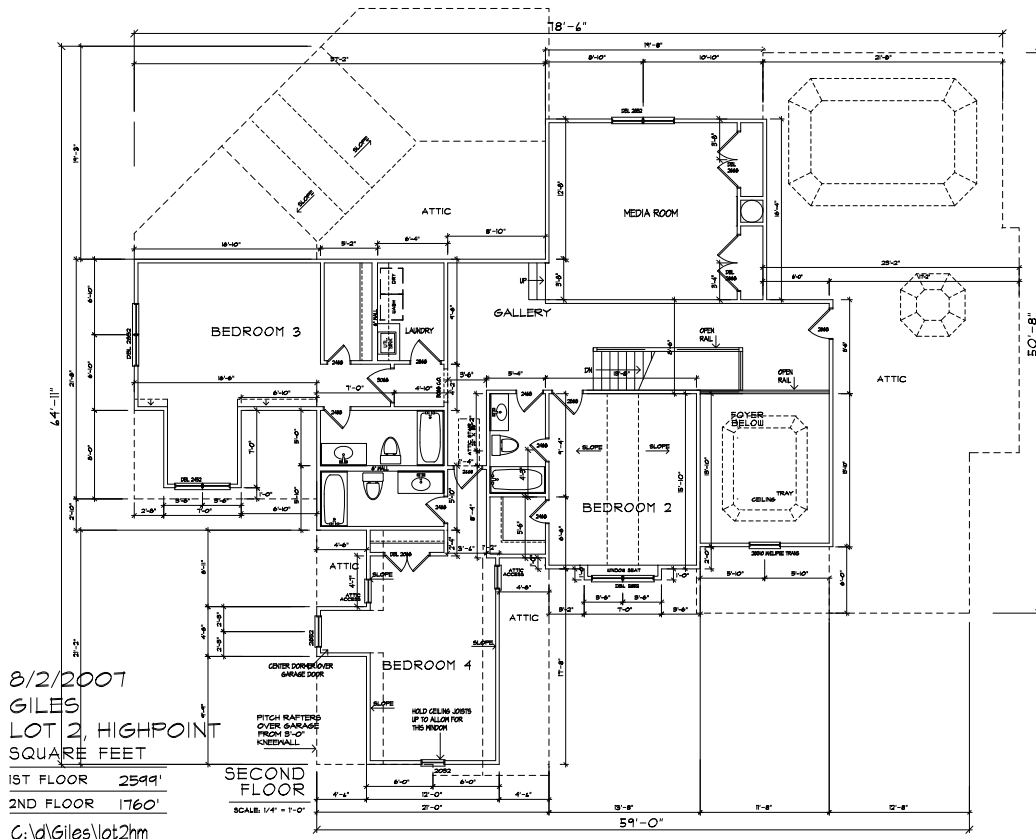

8/2/2007
 GILES
 LOT 2, HIGHPOINT
 SQUARE FEET
 1ST FLOOR 2594'
 2ND FLOOR 1760'
 C:\d\Giles\lot2hm